

Specification Sheet

by WPI

Installation Guide:

The mounting should be in compliance with ADA requirements. Select a location which provides the area forward of the unit for best dispensing function. Location should allow the cover to be opened for product installation, unit maintenance and provide adequate room to use feed wheel located on right side of housing. The following instructions serve as a guide only, and WPI is not liable for damage, injury do to improper installation.

Installation Steps:

1. Select appropriate fasteners for the surface substrate. Failure to do so could result in injury.
2. The unit should be mounted with a minimum of 4 fasteners. It is recommended for best security to position fasteners in the outer most ends of slots.
3. Position unit in desired location, install screw through center keyhole. This will allow the unit to pivot on screw for leveling.
4. Level unit and either install 4 screws or if anchors are required, mark anchor locations.
5. Loosen screw in center keyhole slot and temporally remove unit.
6. Install anchors in marked locations, and reinstall unit back on center screw, align unit with anchors and install 4 screws. Center screw can be either tightened or removed if desired.
7. Six inch minimum from counter or horizontal surface.

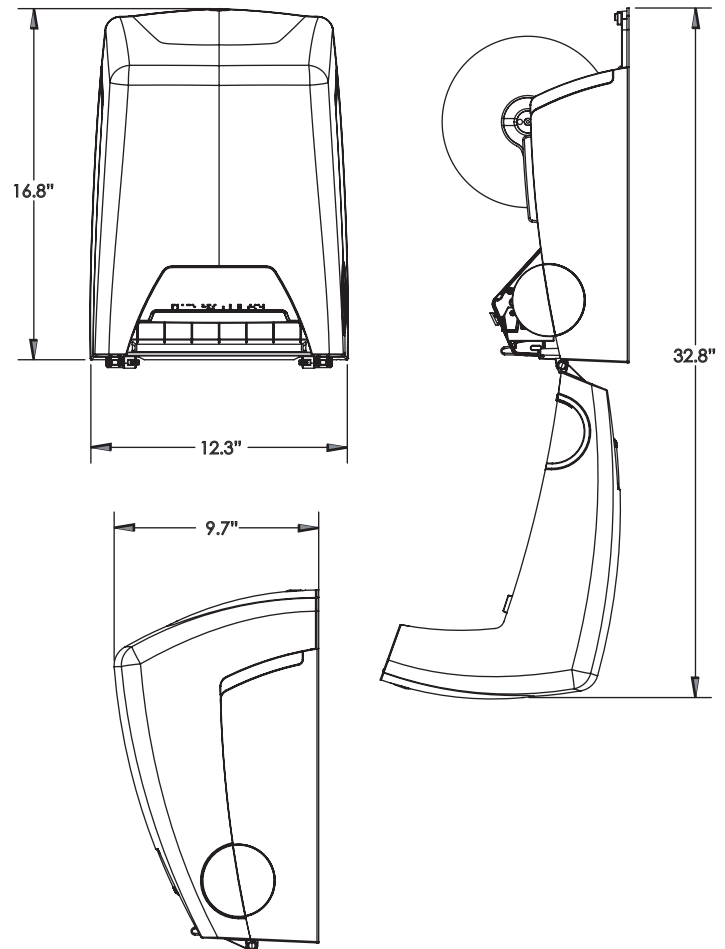

Specifications:

This Mechanical Hands Free Dispenser, is designed to accept one standard hard wound paper roll towel.
Core: 1.5" - 2"; Width: 8"; Diameter: up to 8".

Weight:

Dispenser- 6.3 lbs. (2.86kg)

Dispenser with packaging- 7.9 lbs. (3.58kg)

Overall Dimensions:

Wide: 12.3" (31.3cm)

Height: 16.8" (42.6cm)

Depth: 9.7" (24.6cm)

WISCONSIN PLASTICS, INC.

3155 COMMODITY LANE, GREEN BAY, WI 54304 | PHONE 920 337 2202 | FAX 920 337 4927 | INFO@WISCONSINPLASTICS.COM

Part# 20273-CPP-0128

Rev. A Date: 9-1-24

Patent Pending

Specification Sheet

by WPI

Loading:

1. Insert roll into roll holder.
2. Insert paper into paper feed area.
3. Push feed button.

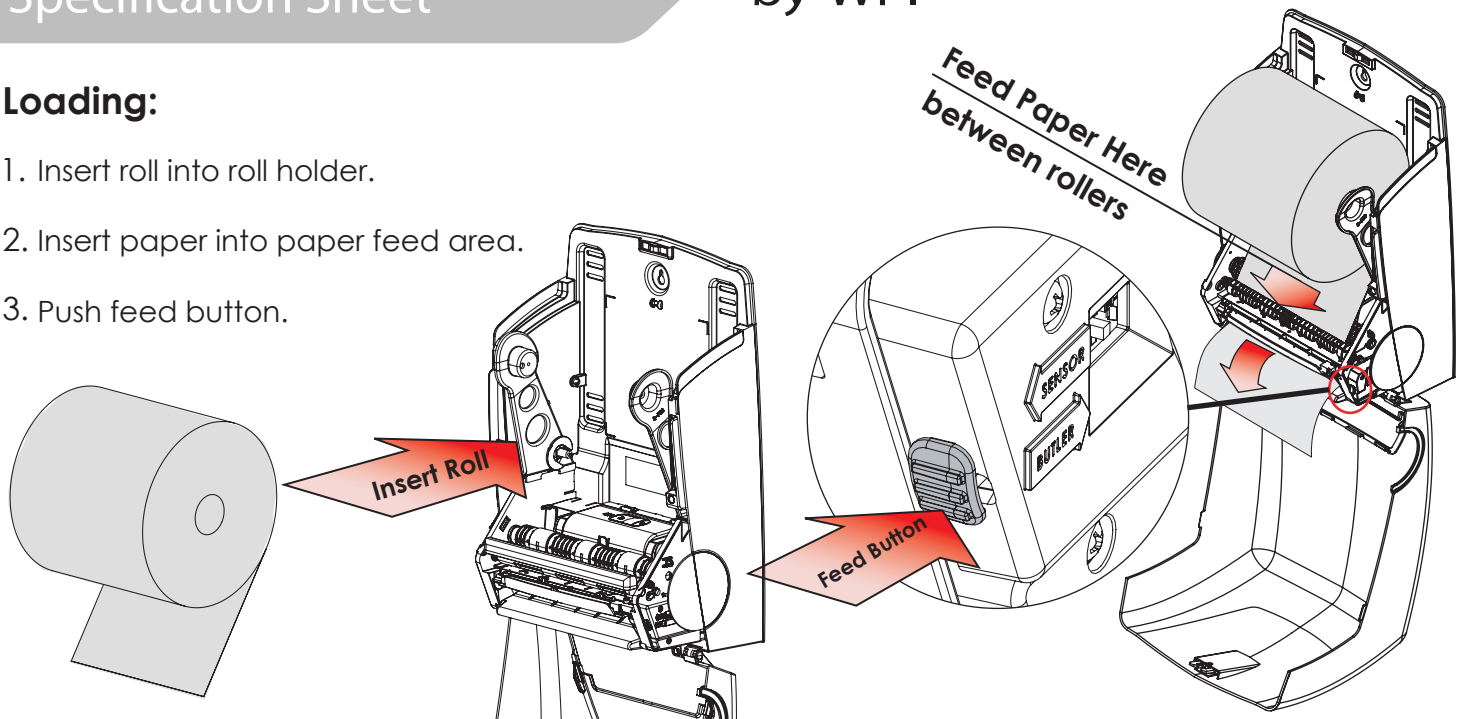

Change batteries:

1. Change batteries when dispenser is flashing yellow or constant red.
2. Open battery cover.
3. Install 4 D cell (alkaline) batteries.
4. Look for battery indicator lights
5. Close battery door.

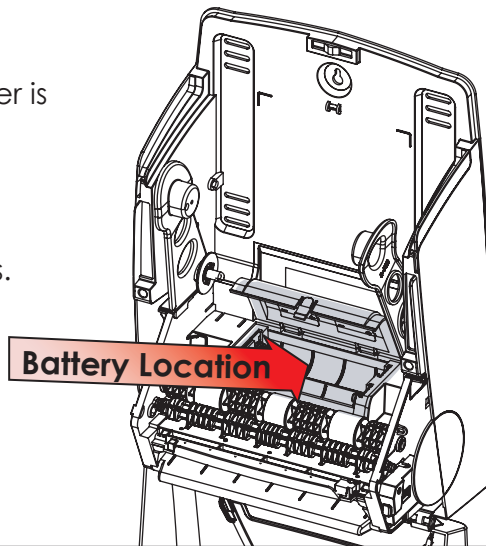

Butler/Sensor Mode:

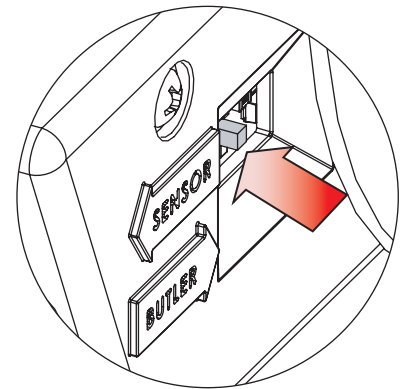

Switch To Forward= Sensor mode
Switch To Back= Butler mode

Indicator Lights

Dispensing Action
Green LED

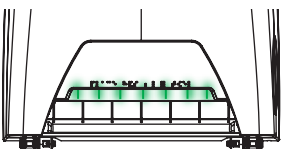

Low Battery
Flashing Yellow

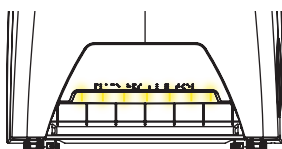

Dead Battery
Constant Red

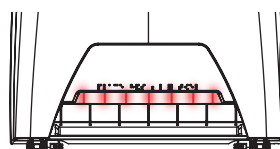

Scan QR code
for instructions

